

Blueprint for Literacy SB 438

Teach Every Child to Read

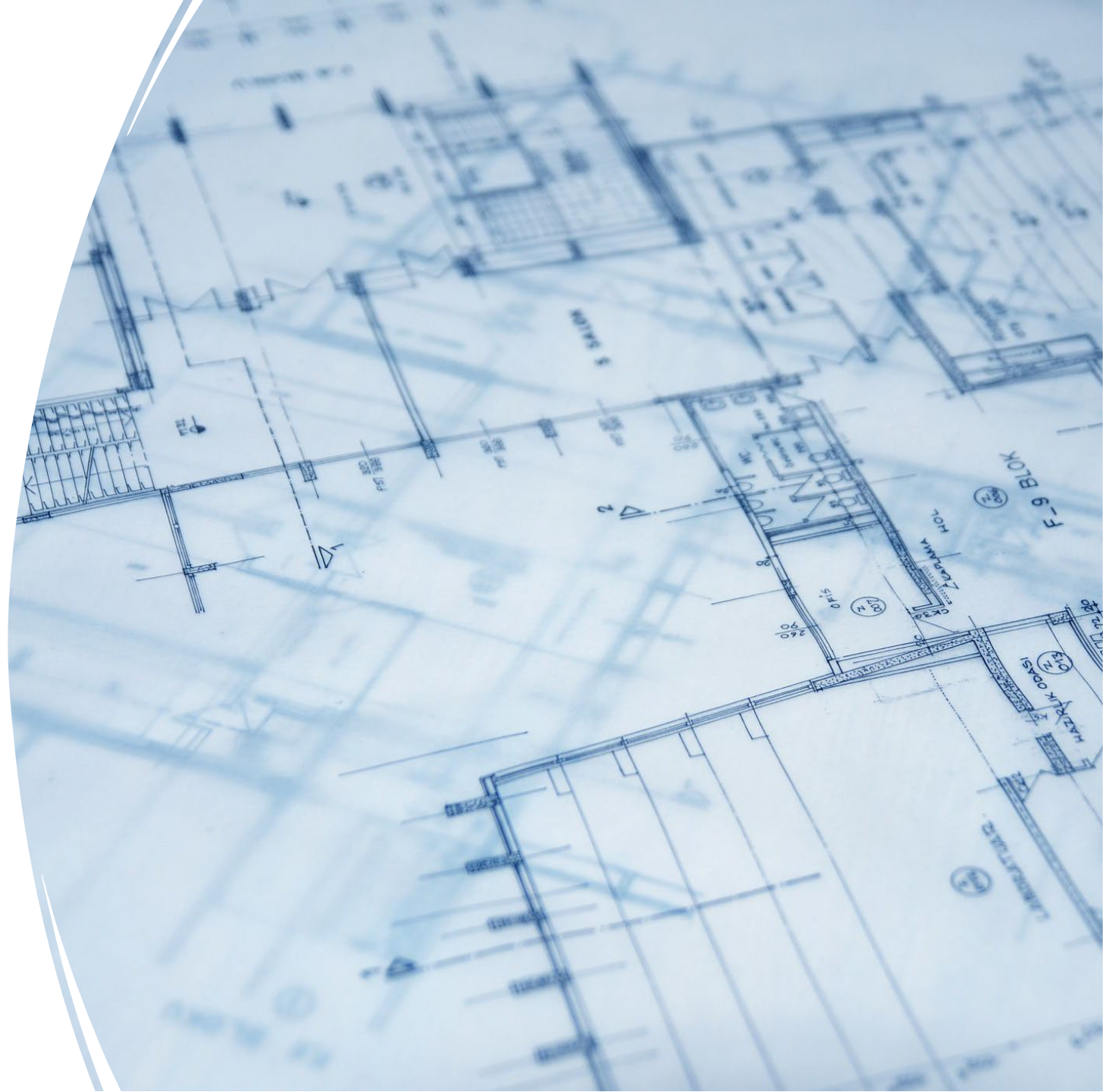

SB 438



Signed into law by Governor Kelly
on April 25, 2024



Establishing the Blueprint for
Literacy

Imperative



Kansas is
experiencing
unprecedented
economic growth

54,000 new jobs
requiring a
bachelor's degree
or higher by 2033
(2023 KU Institute
for Policy and
Social Research)



At the same time 1/3 of Kansas
student are below Basic on the
National Assessment for
Education Progress



National Average 4th Grade Reading Performance 2022

READING

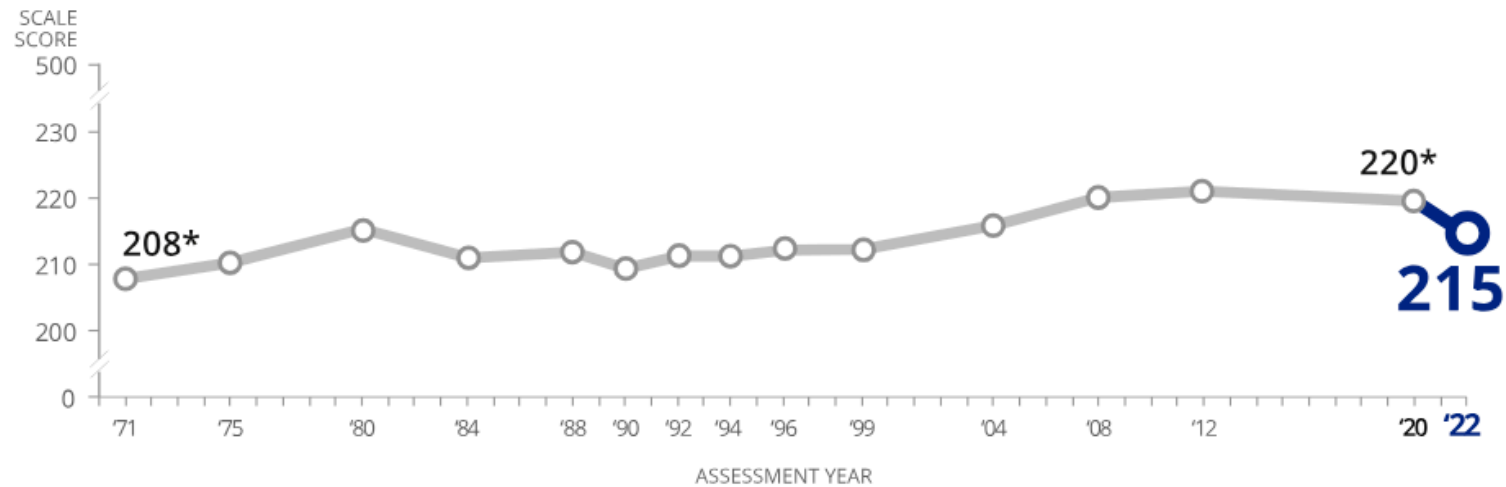

Score change between
2020 and 2022



Largest score drop
in reading
since 1990

NAEP
Achievement-
Level
Percentage and
Average Score
Results

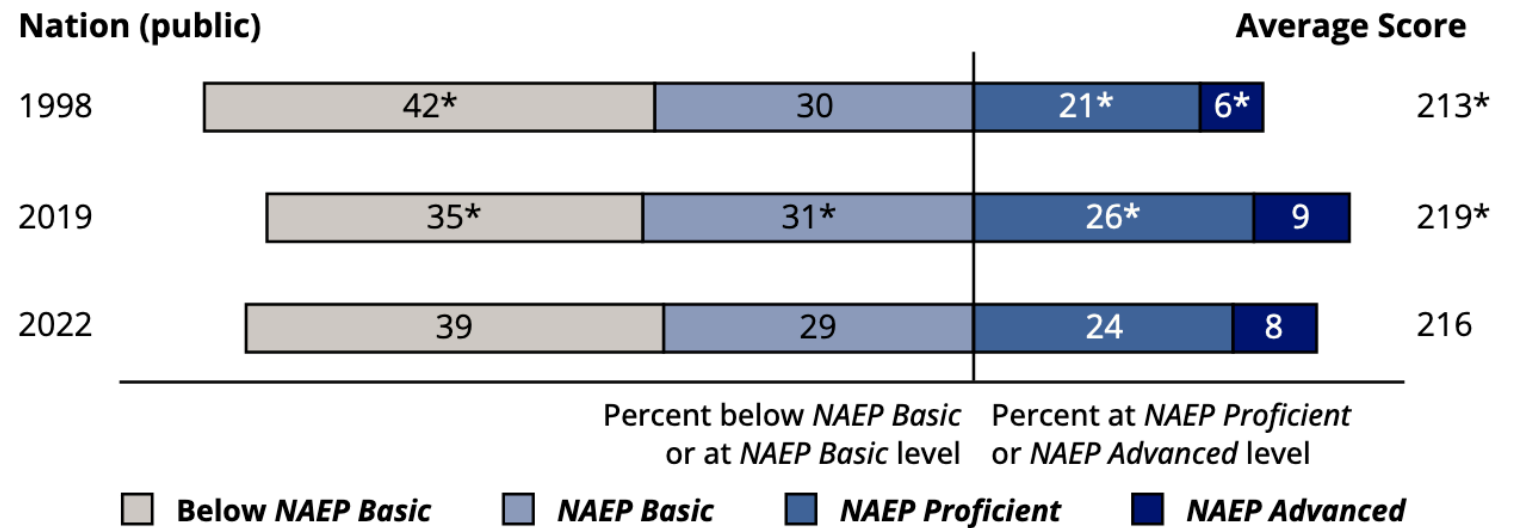

* Significantly different ($p < .05$) from the nation's results in 2022. Significance tests were performed using unrounded numbers.



RESULTS FOR STUDENT GROUPS IN 2022

REPORTING GROUPS	PERCENTAGE OF STUDENTS	AVG. SCORE	PERCENTAGE AT OR ABOVE NAEP		PERCENTAGE AT NAEP ADVANCED
			BASIC	PROFICIENT	
Race/Ethnicity					
White	45	226	72	41	11
Black	15	198	43	16	2
Hispanic	28	204	49	20	4
Asian	6	241	82	58	24
American Indian/Alaska Native	1	198	43	18	3
Native Hawaiian/Pacific Islander	#	206	50	21	5
Two or More Races	5	222	67	37	9
Gender					
Male	51	213	58	30	8
Female	49	219	64	34	9
National School Lunch Program					
Eligible	52	203	48	19	3
Not eligible	47	231	76	46	14

Rounds to zero



MHEC AVERAGE SCORE

NP = 216

8 States ↑

36 States —

8 State ↓

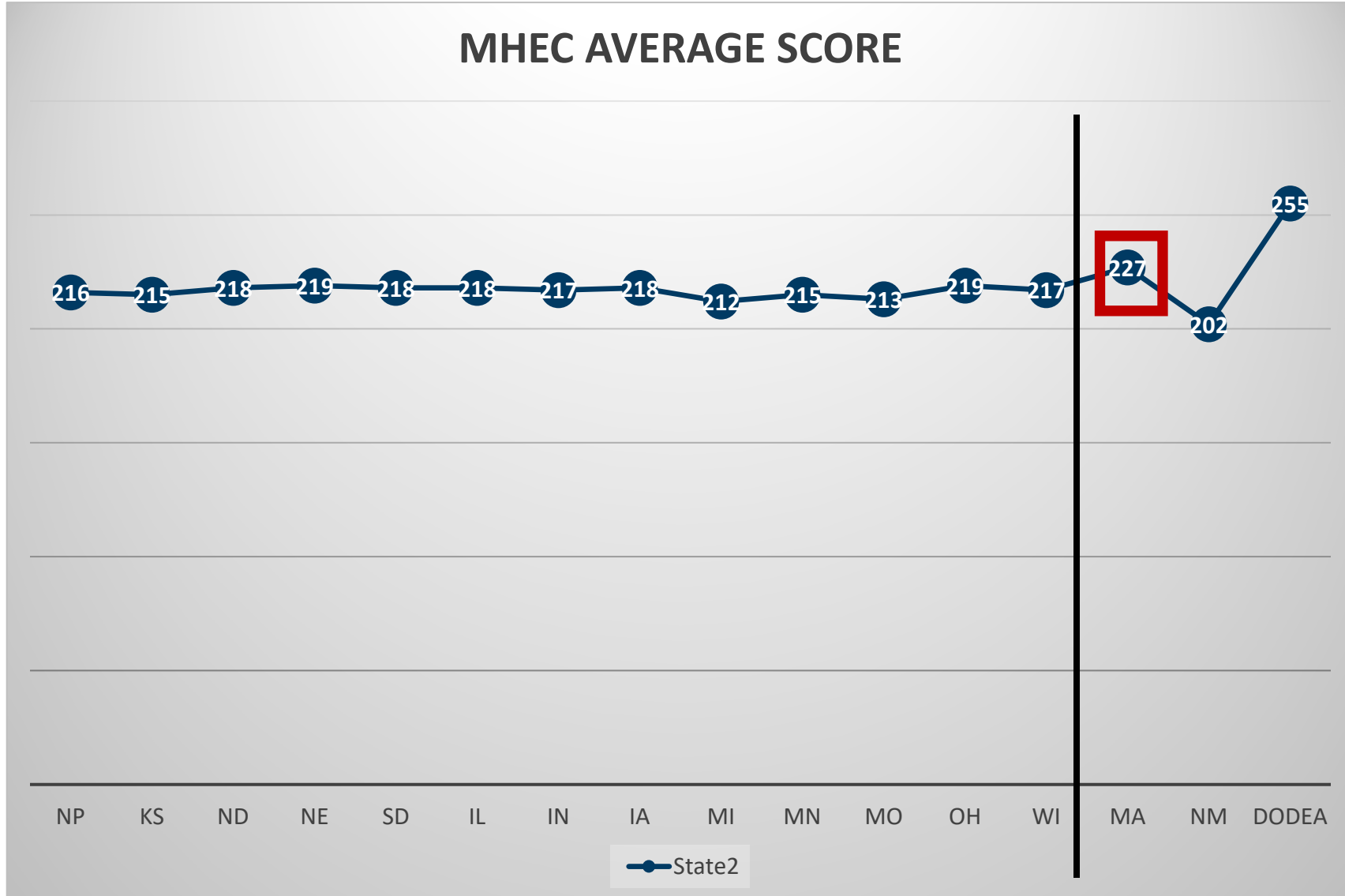



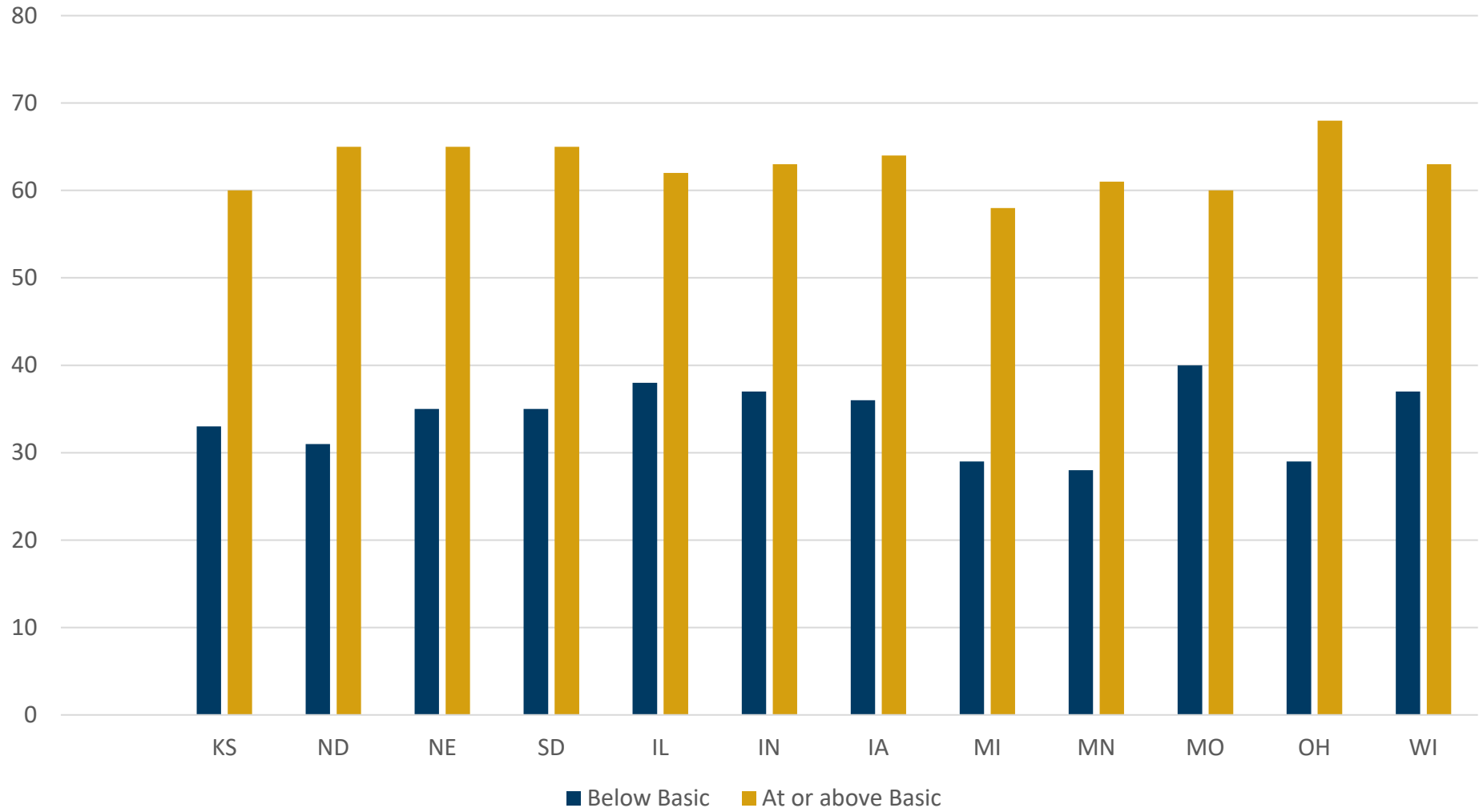

MHEC 4th Grade Reading 2022



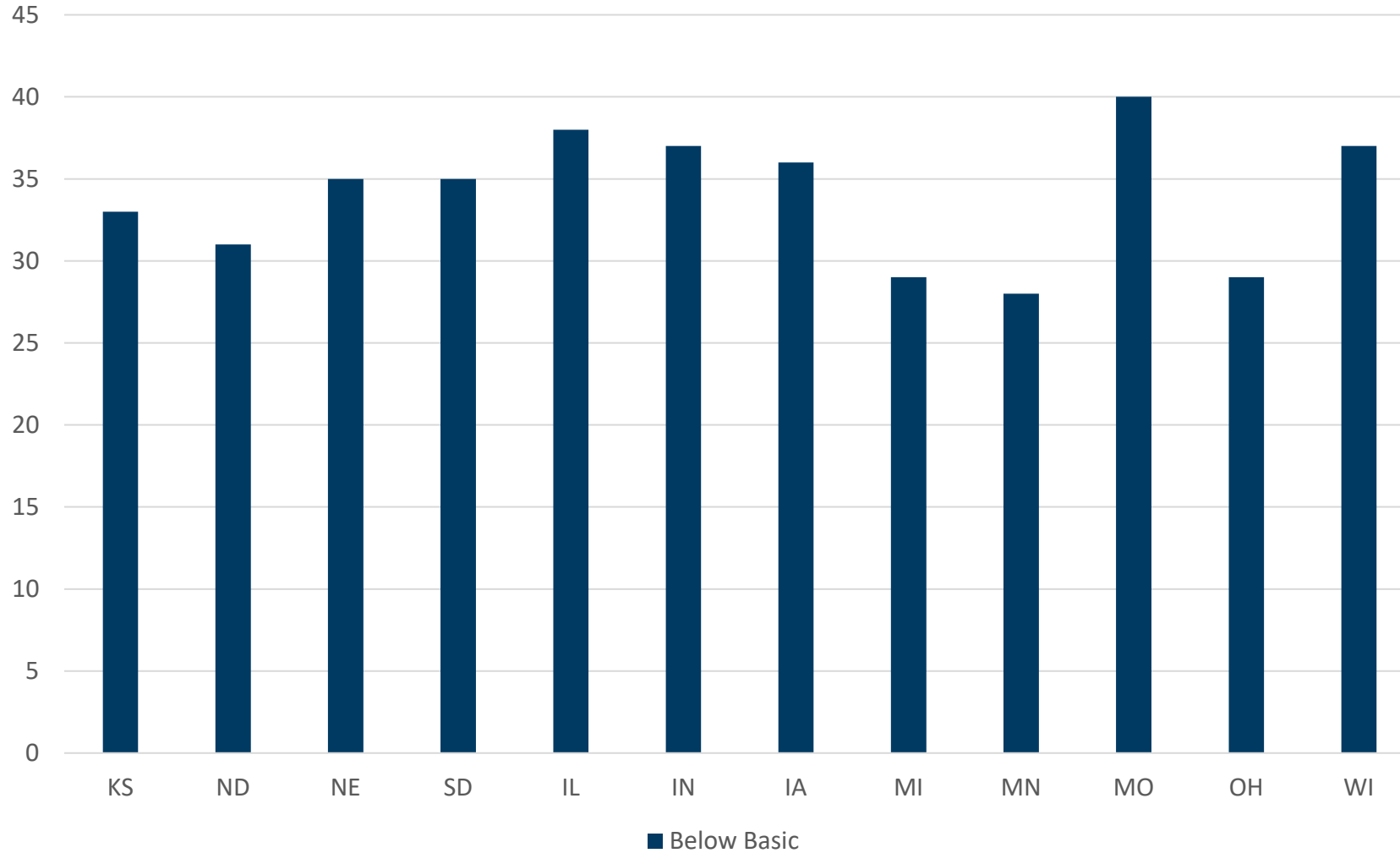

Percentage MHEC 4th Graders Below Basic 2022



A hand holding a blue pencil is writing on a document. The background is blurred, showing a person in a white shirt. The text is overlaid on the image.

Literacy is a Top
Economic Imperative



Top Priority of Higher Education in Kansas

Blueprint for Literacy

Largest workforce development
initiative in the history of Kansas



Providing education and training for
educators in the Science of Reading
(specifically Structured Literacy)

Blueprint as a Key Driver Aligned with KBOR's Strategic Plan

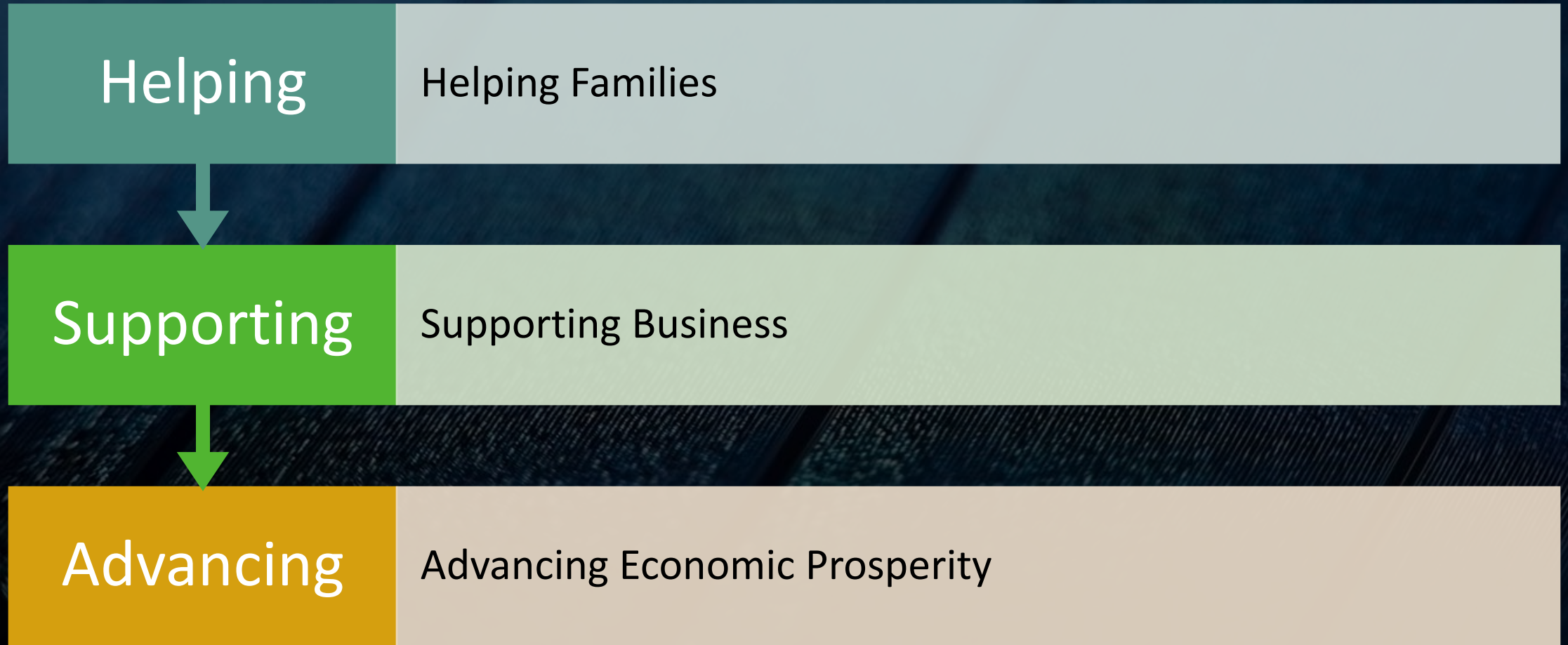

Blueprint for Literacy

Clearly marked path with practical steps

Equip educators with the knowledge and skills needed for success in the classroom



Blueprint Requirements

Director and Advisory
Committee

Science of Reading
and Structured
Literacy

Application and
Common
Performance
Assessment

Comprehensive
Reading and Literacy
Assessment taught in
Educator Preparation

Professional Learning,
Micro-Credential,
Certification
Requirements

Data

Annual systemwide
review of curriculum

Plan for Centers of
Excellence in Reading

Critical Actions

Collaborate
with State
Board of
Education

Focus on
educator
workforce
professional
learning

Strengthen
Educator
Preparation
Programs

Recommend,
Monitor,
Lead

Structure

Kansas Board of Regents

Director of Literacy

- Colleges of Education
- Collaboration with State Department of Education
- Partnerships Private, Independent, Community and Technical Colleges
- Community Literacy Organizations

Advisory Committee

Goal

100% of Elementary Teacher Workforce Achieve a Micro-Credential in the Science of Reading / Structured Literacy by 2030

BY 2033

90% Reading Goal

Leading, Intentional Strategies

Micro-Credential

Plan for Centers of Excellence

Build a Movement

+
•
○

*Science of Reading
Courses and
Credentials for Inservice
Educators*

+
•
○

Science of Reading/ Structure Literacy Courses

High Quality and
Standards Aligned

3rd Party Validation

Graduate Credit
paid by Blueprint for
eligible educators
(market based)

Course is 180 clock
hours

Application

Developed in
Collaboration
between all Public
Universities

Structured Literacy

- Direct
- Systematic
- Cumulative

Master is the Goal



FOUNDATIONS IN SCIENCE OF READING

EQUIP EDUCATORS IN STRUCTURED LITERACY

EXPLICIT

SYSTEMATIC

CUMULATIVE

Assessments

Vocabulary

Oral Language

Morphology

Phonological Awareness

Comprehension

Phonemic Awareness

Syntax

Phonics & Spelling

Text Structure

Fluency

Writing

DESIGNED FOR TEACHERS OF ALL LEARNERS, INCLUDING:

English to Speakers of Other Languages, Dyslexia, & Special Education

INTERACTIVE & MULTI SENSORY

STRATEGIC COACHING OF TEACHING

+
◦ • Core Strategy #2

CENTERS OF EXCELLENCE
IN LITERACY

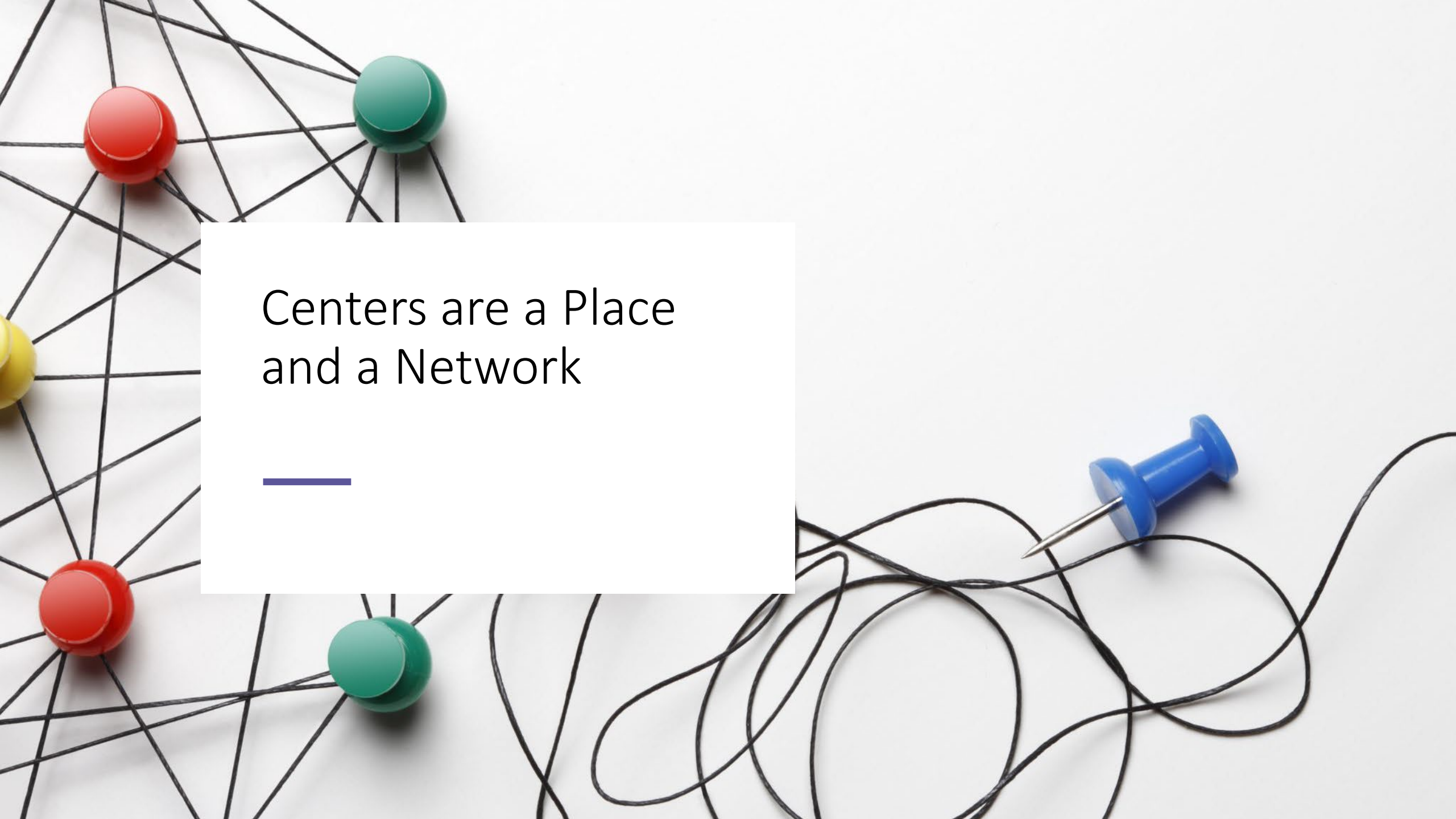

The background features a network diagram on the left side, consisting of several colored nodes (red, green, yellow) connected by black lines. On the right side, there is a blue pushpin with a silver needle, which is pinned to a black string that forms a series of loops. The entire scene is set against a plain white background.

Centers are a Place and a Network





KANSAS BLUEPRINT FOR LITERACY

Centers for Excellence Catchment Area Map

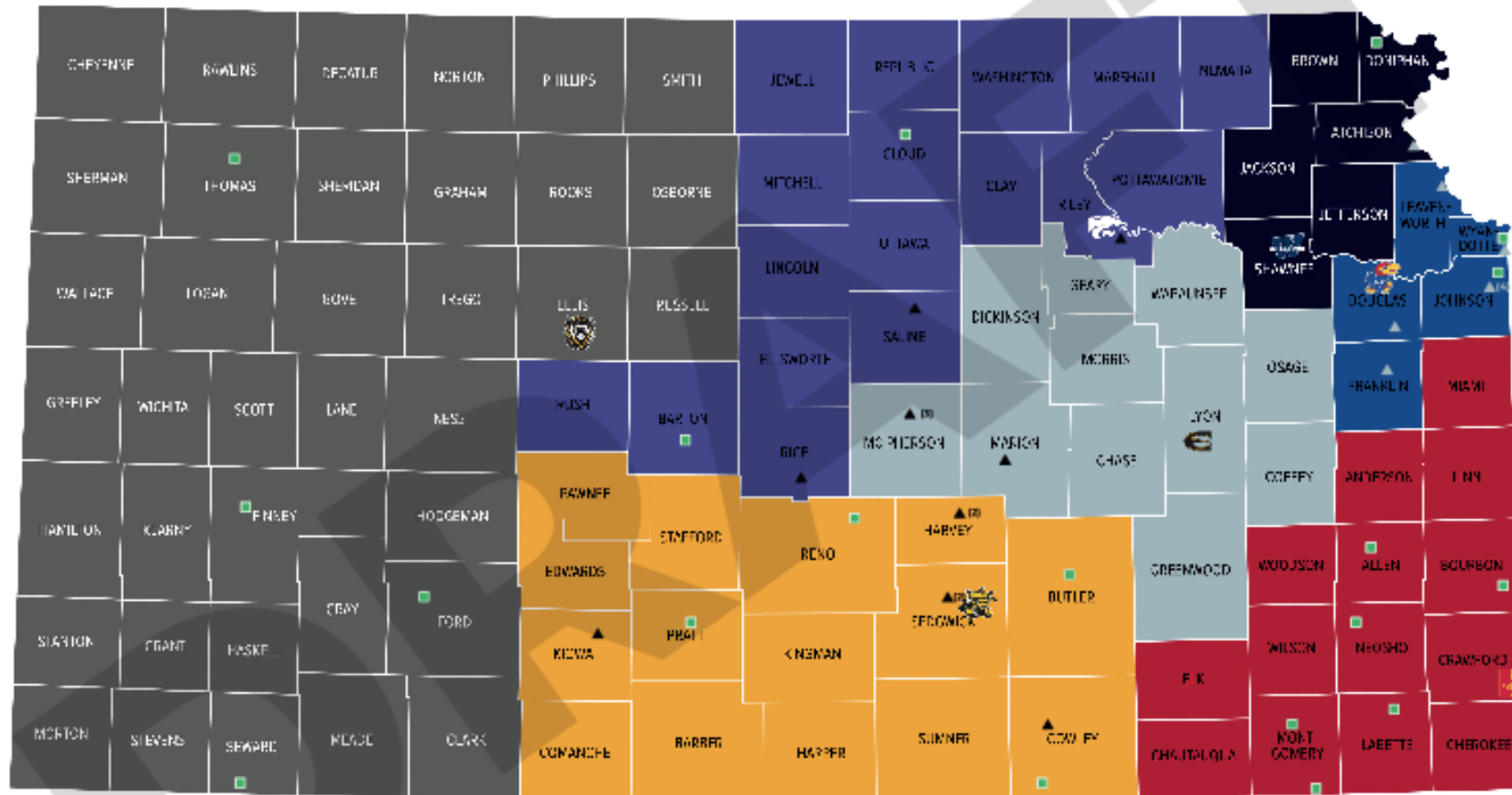

	Emporia State		Kansas		Pittsburg State		Wichita State
	Fort Hays State		Kansas State		Washburn		

- Community Colleges
- Independent Institutions

Centers of Excellence in Literacy

Educators

Prepare
Professional
Learning
Strategic Coaching

Leaders

Prepare
Professional
Learning
Resources

Families

Evaluation,
Assessment
Resources



QUESTIONS?



Mission Possible

Teach Every Child to
Read